

P.G. #85A-18

ca. 1890/1955

Union Bethel A.M.E. Church Site
6810 Floral Park Road, Brandywine, Md.
Priv/Occ/Relig/Site

This is the site of Union Bethel A.M.E. Church, originally a one-story gable-roofed frame building, with entrance in the south gable end. Some years after 1906, a bell tower was built at the southeast corner of the church and the main entrance was shifted to the east side of the bell tower. In 1955, the present building was completed, a gable-roofed brick building, Italianate in design, covered with stucco except for the buttresses and trim around the door and windows. There is a graveyard to the north and west of the church.

In 1868, two acres of land at this site were deeded to trustees of the African Methodist Episcopal Church. It is not certain when the first church building was erected, but services were being held there by 1890, under the guidance of Rev. James G. Martin, in the frame building described above. By 1906, plans were being made for enlarging the church; the Baltimore Conference minutes for that year indicate that the congregation was growing rapidly and that the Pastor was collecting funds for enlarging the building. Within a few years, the bell tower was added, as well as a wing. This frame church burned to the ground in 1948, and was replaced in 1955 by the present building. Union Bethel Church is an important Black historic site, because it is the only remaining African Methodist Episcopal Church in southern Prince George's County; it has absorbed the congregations of Mount Hope and Metropolitan A.M.E. churches after those early churches were demolished.

Maryland Historical Trust State Historic Sites Inventory Form

1. Name (indicate preferred name)

historic Union Bethel African Methodist Episcopal Church

and/or common

2. Location

street & number 6810 Floral Park Road not for publication

city, town Brandywine vicinity of T.B. congressional district 4

state Maryland county Prince George's

3. Classification

Category	Ownership	Status	Present Use
<input type="checkbox"/> district	<input type="checkbox"/> public	<input checked="" type="checkbox"/> occupied	<input type="checkbox"/> agriculture <input type="checkbox"/> museum
<input checked="" type="checkbox"/> building(s)	<input checked="" type="checkbox"/> private	<input type="checkbox"/> unoccupied	<input type="checkbox"/> commercial <input type="checkbox"/> park
<input type="checkbox"/> structure	<input type="checkbox"/> both	<input type="checkbox"/> work in progress	<input type="checkbox"/> educational <input type="checkbox"/> private residence
<input checked="" type="checkbox"/> site	Public Acquisition	Accessible	<input checked="" type="checkbox"/> religious <input type="checkbox"/> scientific
<input type="checkbox"/> object	<input type="checkbox"/> in process	<input checked="" type="checkbox"/> yes: restricted	<input type="checkbox"/> government <input type="checkbox"/> transportation
	<input type="checkbox"/> being considered	<input type="checkbox"/> yes: unrestricted	<input type="checkbox"/> industrial <input type="checkbox"/> other:
	<input type="checkbox"/> not applicable	<input type="checkbox"/> no	

4. Owner of Property (give names and mailing addresses of all owners)

name Trustees of Union-Bethel A.M.E. Church

street & number 6810 Floral Park Road telephone no.: Rev. Mack Bell (736-6292)

city, town Brandywine state and zip code Md.

5. Location of Legal Description

courthouse, registry of deeds, etc. P.G. Co. Courthouse liber J.B.#10-323

street & number Main Street folio H.B.#1-618

city, town Upper Marlboro state Maryland

6. Representation in Existing Historical Surveys

title Prince George's County Inventory of Historic Sites

date 1974 federal state county local

depository for survey records History Division, Calvert Mansion

city, town 4811 Riverdale Rd., Riverdale, state Md. 20737

7. Description

Survey No. P.G.#85A-18

Condition		Check one	Check one
<input checked="" type="checkbox"/> excellent	<input type="checkbox"/> deteriorated	<input type="checkbox"/> unaltered	<input type="checkbox"/> original site
<input type="checkbox"/> good	<input type="checkbox"/> ruins	<input type="checkbox"/> altered	<input type="checkbox"/> moved date of move _____
<input type="checkbox"/> fair	<input checked="" type="checkbox"/> unexposed		

Prepare both a summary paragraph and a general description of the resource and its various elements as it exists today.

This is the site of Union Bethel A.M.E. Church, organized as early as 1868, and built probably ca. 1890. This was originally a one-story gable-roofed frame building, with entrance in the south gable end. Some years after 1906, a bell tower was built at the southeast corner of the church, and the main entrance was shifted to the east side of the bell tower. (The original entrance in the south gable end was replaced by a double pointed-arch window.) A wing was later extended to the east from the main building.

This frame church burned to the ground in 1948, and the present church was built in 1955. It is a gable-roofed brick building (covered with stucco except for buttresses, and trim around the door and windows), with entry through a vestibule-tower centered in the south facade. It is Italianate in design.

There is a graveyard to the north and west of the church.

8. Significance

Survey No. P.G.#85A-18

Period	Areas of Significance—Check and justify below			
<input type="checkbox"/> prehistoric	<input type="checkbox"/> archeology-prehistoric	<input type="checkbox"/> community planning	<input type="checkbox"/> landscape architecture	<input checked="" type="checkbox"/> religion
<input type="checkbox"/> 1400-1499	<input type="checkbox"/> archeology-historic	<input type="checkbox"/> conservation	<input type="checkbox"/> law	<input type="checkbox"/> science
<input type="checkbox"/> 1500-1599	<input type="checkbox"/> agriculture	<input type="checkbox"/> economics	<input type="checkbox"/> literature	<input type="checkbox"/> sculpture
<input type="checkbox"/> 1600-1699	<input type="checkbox"/> architecture	<input type="checkbox"/> education	<input type="checkbox"/> military	<input type="checkbox"/> social/ humanitarian
<input type="checkbox"/> 1700-1799	<input type="checkbox"/> art	<input type="checkbox"/> engineering	<input type="checkbox"/> music	<input type="checkbox"/> theater
<input type="checkbox"/> 1800-1899	<input type="checkbox"/> commerce	<input type="checkbox"/> exploration/settlement	<input type="checkbox"/> philosophy	<input type="checkbox"/> transportation
<input checked="" type="checkbox"/> 1900-	<input type="checkbox"/> communications	<input type="checkbox"/> industry	<input type="checkbox"/> politics/government	<input checked="" type="checkbox"/> other (specify) Black History
		<input type="checkbox"/> invention		

Specific dates (1868)/1906/1955 Builder/Architect

check: Applicable Criteria: A B C D
and/or
Applicable Exception: A B C D E F G
Level of Significance: national state local

Prepare both a summary paragraph of significance and a general statement of history and support.

In 1868, Jane P. Williams deeded two acres of land to the trustees of the African Methodist Episcopal Church. It is not certain when the first church building was erected on the land, but services were being held there by 1890, under the guidance of Rev. James G. Martin. An adjoining piece of land (1 1/2 acres) was purchased from Jane Williams in 1900 and the graveyard was extended to the west.

The church building at the turn of the century was a simple frame gable-roofed structure, with entrance in the south gable end, but by 1906 plans were being made for enlarging the church. The Baltimore Conference minutes of that year indicate considerable growth in the congregation under Rev. Joseph Cordell: "This is one of the best circuits within the bounds of our Conference. It is growing so rapidly in population that it will in a short time demand the entire services of a pastor. The church building is inadequate to accommodate the people...therefore the pastor and members are collecting funds to enlarge the building. Elder Cordell already collected some money for rebuilding purposes."

Within a few years, a bell tower was built at the southeast corner, and the main entrance was shifted to the east side of the tower. An east wing was also constructed.

This frame church was burned to the ground on New Year's Day 1948. Services were held in the social hall to the east while plans were made to rebuild the church. This was finally accomplished in 1955 under the pastorate of Rev. Daniel Makel.

Union Bethel Church had for many years been on the circuit with Mount Hope A.M.E. Church in Camp Springs, and Metropolitan A.M.E. Church in Clinton. During the 1960's these two churches were abandoned and their congregations merged with that of Union Bethel.

9. Major Bibliographical References

Survey No. P.G.#85A-18

P.G. Co. Deeds J.B. #10:323; H.B. #1:618
Baltimore Conference Minutes, A.M.E. Church 1906
Souvenir Booklet, Union Bethel A.M.E. Church 1976
Interviews with pastor and members of Union Bethel, March 1983

10. Geographical Data

Acreage of nominated property _____

Quadrangle name _____

Quadrangle scale _____

UTM References do NOT complete UTM references

A

Zone	Easting							Northing	

B

Zone	Easting							Northing	

C

Zone	Easting							Northing	

D

Zone	Easting							Northing	

E

Zone	Easting							Northing	

F

Zone	Easting							Northing	

G

Zone	Easting							Northing	

H

Zone	Easting							Northing	

Verbal boundary description and justification

List all states and counties for properties overlapping state or county boundaries

state code county code

state code county code

11. Form Prepared By

name/title Susan G. Pearl

organization History Division, M-NCPPC

date March 1983

street & number 4811 Riverdale Rd.

telephone 779-2011

city or town Riverdale

state Maryland 20737

The Maryland Historic Sites Inventory was officially created by an Act of the Maryland Legislature to be found in the Annotated Code of Maryland, Article 41, Section 181 KA, 1974 supplement.

The survey and inventory are being prepared for information and record purposes only and do not constitute any infringement of individual property rights.

return to: Maryland Historical Trust
Shaw House
21 State Circle
Annapolis, Maryland 21401
(301) 269-2438



P. G. #85A-18

Union-Bethel A.M.E. Church
Prince George's County, Md.
Susan G. Pearl
January 1983
Southeast 3/4 elevation
Neg: Md. Hist. Trust, Annapolis, Md.

Prince George's - 85A-18
Union-Bethel A.M.E. Church (Site)
Floral Park Road
Brandywine, MD 20613

1893, 1955, 1963

Access: Public

Union-Bethel A.M.E. Church stands twenty feet from the north side of Floral Park Road (off Route 373), 2½ miles west of Brandywine.

The original church on this site was Union A.M.E. It combined with Bethel A.M.E. shortly after the turn of the present century. Union-Bethel later took in the Mt. Hope A.M.E. congregation (Allentown Road) and the Metropolitan A.M.E. congregation (Piscataway Road, Clinton, MD).

Union-Bethel is the last African Methodist Episcopal congregation left in this area of Prince George's County. A church was built on this site in 1893. That church was rebuilt in 1955 and burned to the ground on New Year's Eve, 1962. The present structure dates from 1963.

MARYLAND HISTORICAL TRUST

PG 85A-18
MAGI#1785A244808 27

INVENTORY FORM FOR STATE HISTORIC SITES SURVEY

1 NAME

HISTORIC

UNION-BETHEL A.M.E. CHURCH (SITE)

AND/OR COMMON

2 LOCATION

STREET & NUMBER

Floral Park Rd.

CITY, TOWN

Brandywine

VICINITY OF

CONGRESSIONAL DISTRICT

Fourth

STATE

Maryland

COUNTY

Prince Georges

3 CLASSIFICATION

CATEGORY	OWNERSHIP	STATUS	PRESENT USE
<input type="checkbox"/> DISTRICT	<input type="checkbox"/> PUBLIC	<input checked="" type="checkbox"/> OCCUPIED	<input type="checkbox"/> AGRICULTURE <input type="checkbox"/> MUSEUM
<input type="checkbox"/> BUILDING(S)	<input checked="" type="checkbox"/> PRIVATE	<input type="checkbox"/> UNOCCUPIED	<input type="checkbox"/> COMMERCIAL <input type="checkbox"/> PARK
<input checked="" type="checkbox"/> STRUCTURE	<input type="checkbox"/> BOTH	<input type="checkbox"/> WORK IN PROGRESS	<input type="checkbox"/> EDUCATIONAL <input type="checkbox"/> PRIVATE RESIDENCE
<input checked="" type="checkbox"/> SITE	PUBLIC ACQUISITION	ACCESSIBLE	<input type="checkbox"/> ENTERTAINMENT <input checked="" type="checkbox"/> RELIGIOUS
<input type="checkbox"/> OBJECT	<input type="checkbox"/> IN PROCESS	<input checked="" type="checkbox"/> YES: RESTRICTED	<input type="checkbox"/> GOVERNMENT <input type="checkbox"/> SCIENTIFIC
	<input type="checkbox"/> BEING CONSIDERED	<input type="checkbox"/> YES: UNRESTRICTED	<input type="checkbox"/> INDUSTRIAL <input type="checkbox"/> TRANSPORTATION
		<input type="checkbox"/> NO	<input type="checkbox"/> MILITARY <input type="checkbox"/> OTHER:

4 OWNER OF PROPERTY

NAME Trustees, Union-Bethel AME Church

Telephone #: N/A

STREET & NUMBER

Floral Park Rd.

CITY, TOWN

Brandywine

VICINITY OF

STATE, zip code
MD, 20613

5 LOCATION OF LEGAL DESCRIPTION

COURTHOUSE, REGISTRY OF DEEDS, ETC. Prince Georges CO. Court House

Liber #: JWB 19

Folio #: 444

STREET & NUMBER

CITY, TOWN

Upper Marlboro

STATE

Maryland

6 REPRESENTATION IN EXISTING SURVEYS

TITLE
N/A

DATE

FEDERAL STATE COUNTY LOCAL

DEPOSITORY FOR SURVEY RECORDS

CITY, TOWN

STATE

7 DESCRIPTION

CONDITION		CHECK ONE		CHECK ONE	
<input checked="" type="checkbox"/> EXCELLENT	<input type="checkbox"/> DETERIORATED	<input type="checkbox"/> UNALTERED	<input checked="" type="checkbox"/> ORIGINAL SITE	<input type="checkbox"/> MOVED	DATE <u>1893</u>
<input type="checkbox"/> GOOD	<input type="checkbox"/> RUINS	<input checked="" type="checkbox"/> ALTERED			
<input type="checkbox"/> FAIR	<input type="checkbox"/> UNEXPOSED				

DESCRIBE THE PRESENT AND ORIGINAL (IF KNOWN) PHYSICAL APPEARANCE

Union-Bethel AME Church stands 20' from the north side of Floral Park Rd. (off Rt. 373), 2 1/2 miles west of the Brandywine intersection on Rt. 301. A church was built on this site in 1893; that church was rebuilt in 1955. That structure burned to the ground on New Year's Eve, 1962. The new church was built in 1963. It is Italianate and stucco over brick. Photographs are attached.

8 SIGNIFICANCE

MAJOR HISTORICAL REFERENCES

PERIOD	AREAS OF SIGNIFICANCE -- CHECK AND JUSTIFY BELOW			
<input type="checkbox"/> PREHISTORIC	<input type="checkbox"/> ARCHEOLOGY-PREHISTORIC	<input type="checkbox"/> COMMUNITY PLANNING	<input type="checkbox"/> LANDSCAPE ARCHITECTURE	<input checked="" type="checkbox"/> RELIGION
<input type="checkbox"/> 1400-1499	<input type="checkbox"/> ARCHEOLOGY-HISTORIC	<input type="checkbox"/> CONSERVATION	<input type="checkbox"/> LAW	<input type="checkbox"/> SCIENCE
<input type="checkbox"/> 1500-1599	<input type="checkbox"/> AGRICULTURE	<input type="checkbox"/> ECONOMICS	<input type="checkbox"/> LITERATURE	<input type="checkbox"/> SCULPTURE
<input type="checkbox"/> 1600-1699	<input type="checkbox"/> ARCHITECTURE	<input checked="" type="checkbox"/> EDUCATION	<input type="checkbox"/> MILITARY	<input checked="" type="checkbox"/> SOCIAL/HUMANITARIAN
<input checked="" type="checkbox"/> 1700-1799	<input type="checkbox"/> ART	<input type="checkbox"/> ENGINEERING	<input type="checkbox"/> MUSIC	<input type="checkbox"/> THEATER
<input checked="" type="checkbox"/> 1800-1899	<input type="checkbox"/> COMMERCE	<input type="checkbox"/> EXPLORATION/SETTLEMENT	<input type="checkbox"/> PHILOSOPHY	<input type="checkbox"/> TRANSPORTATION
<input type="checkbox"/> 1900-	<input type="checkbox"/> COMMUNICATIONS	<input type="checkbox"/> INDUSTRY	<input type="checkbox"/> POLITICS/GOVERNMENT	<input type="checkbox"/> OTHER (SPECIFY)
		<input type="checkbox"/> INVENTION		

SPECIFIC DATES 1893-1955-1963 BUILDER/ARCHITECT

STATEMENT OF SIGNIFICANCE

The original church on this site was Union AME Church . This church combined with Bethel AME Church shortly after the turn of the present century. Union-Bethel later took in the Mt.Hope AME Church congregation (Allentown Rd.) and the Metropolitan AME congregation (Piscataway Rd., Clinton, MD) . Union-Bethel AME is the last African Methodist Episcopal congregation left in this area of Prince Georges County. This congregation has long been active. The cemetery at the south of the present church contains the remains of the late Rev. George A. Hawkins who once served at Old Mt. Moriah AME Church in Annapolis. Union-Bethel was the Rev. Hawkins' home parish. There was an old school house on this property that was destroyed many years ago.

9 MAJOR BIBLIOGRAPHICAL REFERENCES

CONTINUE ON SEPARATE SHEET IF NECESSARY

10 GEOGRAPHICAL DATA

ACREAGE OF NOMINATED PROPERTY _____

VERBAL BOUNDARY DESCRIPTION

LIST ALL STATES AND COUNTIES FOR PROPERTIES OVERLAPPING STATE OR COUNTY BOUNDARIES

STATE	COUNTY
STATE	COUNTY

11 FORM PREPARED BY

NAME / TITLE		DATE
James W. Clark, Historic Sites Surveyor		
ORGANIZATION		DATE
Maryland Commission on Afro-American History & Culture		
STREET & NUMBER	TELEPHONE	
20 Dean St.	269-2893	
CITY OR TOWN	STATE	
Annapolis	Maryland	

The Maryland Historic Sites Inventory was officially created by an Act of the Maryland Legislature, to be found in the Annotated Code of Maryland, Article 41, Section 181 KA, 1974 Supplement.

The Survey and Inventory are being prepared for information and record purposes only and do not constitute any infringement of individual property rights.

RETURN TO: Maryland Historical Trust
The Shaw House, 21 State Circle
Annapolis, Maryland 21401
(301) 267-1438

38° 45'

4290

330 000
FEET

4289

4288

4287

4286

42'30"

4285

4284

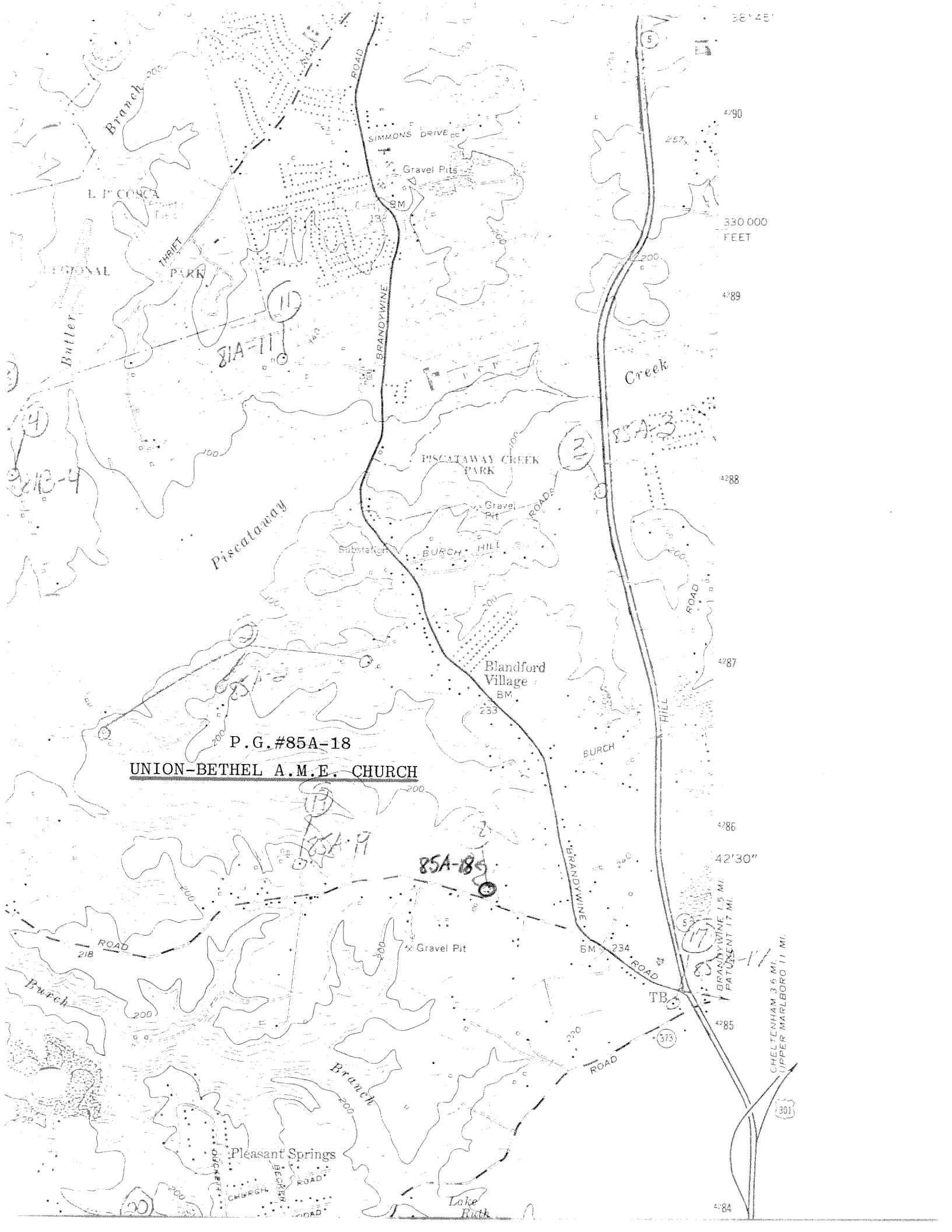

P.G. #85A-18
UNION-BETHEL A.M.E. CHURCH

85A-185

BRANDYSWINE 1.5 MI.
 PATUENT 17 MI.
 85A-11

CHELTENHAM 3.6 MI.
 UPPER MARLBORO 11 MI.

301



PG: 85A-18

Union-Bethel A.M.E. Church (Site) PG85A24
Brandywine, Prince George's County, MD
Michael Hosford

Maryland Historical Trust, Annapolis, MD
South elevation
1/81



Union-Bethel A.M.E. Church(Site) PG85A-18
Brandywine, Prince George's County, MD
Michael Hosford

Maryland Historical Trust, Annapolis, MD
Southeast elevation
1/81

1704394808
PA. # 85A-18

MARYLAND HISTORICAL TRUST WORKSHEET

NOMINATION FORM
for the
NATIONAL REGISTER OF HISTORIC PLACES, NATIONAL PARKS SERVICE

SEE INSTRUCTIONS

1. NAME				
COMMON: Bethel A.M.E. Church				
AND/OR HISTORIC: Bethel Methodist Episcopal Church & Rectory				
2. LOCATION				
STREET AND NUMBER: Floral Park Road				
CITY OR TOWN: Brandywine				
STATE: Maryland		COUNTY: Prince George's		
3. CLASSIFICATION				
CATEGORY (Check One)		OWNERSHIP		STATUS
<input type="checkbox"/> District <input checked="" type="checkbox"/> Building <input type="checkbox"/> Site <input type="checkbox"/> Structure <input type="checkbox"/> Object		<input type="checkbox"/> Public <input checked="" type="checkbox"/> Private <input type="checkbox"/> Both		<input checked="" type="checkbox"/> Occupied <input type="checkbox"/> Unoccupied <input type="checkbox"/> Preservation work in progress
		Public Acquisition: <input type="checkbox"/> In Process <input type="checkbox"/> Being Considered		ACCESSIBLE TO THE PUBLIC Yes: <input checked="" type="checkbox"/> Restricted <input type="checkbox"/> Unrestricted <input type="checkbox"/> No
PRESENT USE (Check One or More as Appropriate)				
<input type="checkbox"/> Agricultural	<input type="checkbox"/> Government	<input type="checkbox"/> Park	<input type="checkbox"/> Transportation	<input type="checkbox"/> Comments
<input type="checkbox"/> Commercial	<input type="checkbox"/> Industrial	<input checked="" type="checkbox"/> Private Residence	<input type="checkbox"/> Other (Specify)	_____
<input type="checkbox"/> Educational	<input type="checkbox"/> Military	<input checked="" type="checkbox"/> Religious	_____	_____
<input type="checkbox"/> Entertainment	<input type="checkbox"/> Museum	<input type="checkbox"/> Scientific	_____	_____
4. OWNER OF PROPERTY				
OWNER'S NAME Trustees of Bethel A.M.E. Church				
STREET AND NUMBER: Floral Park Road				
CITY OR TOWN: Brandywine		STATE: Maryland		
5. LOCATION OF LEGAL DESCRIPTION				
COURTHOUSE, REGISTRY OF DEEDS, ETC.: Prince George's County Courthouse				
STREET AND NUMBER:				
CITY OR TOWN: Upper Marlboro		STATE: Maryland		
Title Reference of Current Deed (Book & Pg. #):				
6. REPRESENTATION IN EXISTING SURVEYS				
TITLE OF SURVEY: None				
DATE OF SURVEY:				
DEPARTMENT FOR SURVEY RECORDS: <input type="checkbox"/> Federal <input type="checkbox"/> State <input type="checkbox"/> County <input type="checkbox"/> Local				
STREET AND NUMBER:				
CITY OR TOWN:		STATE:		

7. DESCRIPTION	
CONDITION	(Check One)
	<input type="checkbox"/> Excellent <input checked="" type="checkbox"/> Good <input type="checkbox"/> Fair <input type="checkbox"/> Deteriorated <input type="checkbox"/> Ruins <input type="checkbox"/> Unexposed
	(Check One)
	<input checked="" type="checkbox"/> Altered <input type="checkbox"/> Unaltered
	(Check One)
	<input type="checkbox"/> Moved <input checked="" type="checkbox"/> Original Site
DESCRIBE THE PRESENT AND ORIGINAL (if known) PHYSICAL APPEARANCE	
<p style="text-align: center;">The church building, dating from 1955, is on the site of previous church buildings.</p> <p style="text-align: center;">The rectory is a two story frame structure with a three bay main (south) facade. The facade has a central gable and one story porch.</p>	

SEE INSTRUCTIONS

B. SIGNIFICANCE

PERIOD (Check One or More as Appropriate)

- Pre-Columbian 16th Century 18th Century 20th Century
- 15th Century 17th Century 19th Century

SPECIFIC DATE(S) (If Applicable and Known)

AREAS OF SIGNIFICANCE (Check One or More as Appropriate)

- | | | | |
|--|--|---|---|
| <p>Aboriginal</p> <ul style="list-style-type: none"> <input type="checkbox"/> Prehistoric <input type="checkbox"/> Historic | <ul style="list-style-type: none"> <input type="checkbox"/> Education <input type="checkbox"/> Engineering <input type="checkbox"/> Industry <input type="checkbox"/> Invention <input type="checkbox"/> Landscape Architecture <input type="checkbox"/> Literature <input type="checkbox"/> Military <input type="checkbox"/> Music | <ul style="list-style-type: none"> <input type="checkbox"/> Political <input type="checkbox"/> Religion/Philosophy <input type="checkbox"/> Science <input type="checkbox"/> Sculpture <input type="checkbox"/> Social/Humanitarian <input type="checkbox"/> Theater <input type="checkbox"/> Transportation | <ul style="list-style-type: none"> <input type="checkbox"/> Urban Planning <input type="checkbox"/> Other (Specify) <hr/> <hr/> <hr/> <hr/> <hr/> <hr/> <hr/> <hr/> |
|--|--|---|---|

STATEMENT OF SIGNIFICANCE

SEE INST. INSTRUCTIONS

9. MAJOR BIBLIOGRAPHICAL REFERENCES

10. GEOGRAPHICAL DATA

LATITUDE AND LONGITUDE COORDINATES DEFINING A RECTANGLE LOCATING THE PROPERTY			O R	LATITUDE AND LONGITUDE COORDINATES DEFINING THE CENTER POINT OF A PROPERTY OF LESS THAN TEN ACRES		
CORNER	LATITUDE	LONGITUDE		LATITUDE	LONGITUDE	
	Degrees Minutes Seconds	Degrees Minutes Seconds		Degrees Minutes Seconds	Degrees Minutes Seconds	
NW	° ' "	° ' "		° ' "	° ' "	
NE	° ' "	° ' "		° ' "	° ' "	
SE	° ' "	° ' "		° ' "	° ' "	
SW	° ' "	° ' "		° ' "	° ' "	

APPROXIMATE ACREAGE OF NOMINATED PROPERTY:

Acreage Justification:

SEE INSTRUCTIONS

11. FORM PREPARED BY

NAME AND TITLE:
Christopher Owens, Park Historian

ORGANIZATION: M-NCPPC

DATE: 31 Jul 74

STREET AND NUMBER:
8787 Georgia Avenue

CITY OR TOWN: Silver Spring

STATE: Maryland

12. State Liaison Officer Review: (Office Use Only)

Significance of this property is:

National State Local

Signature _____

PISCATAWAY QUADR. MARYLAND
7.5 MINUTE SERIES (TOPOGRAPHIC)

NW/4 BRANDYWINE 15 QUADRANGLE
8.4 MI TO SUITLAND PARKWAY
CAMP SPRINGS 4.2 MI

5.5 MI TO D.C. LINE
CLINTON 1 MI

830 000 FEET

76° 52' 30"

38 45'

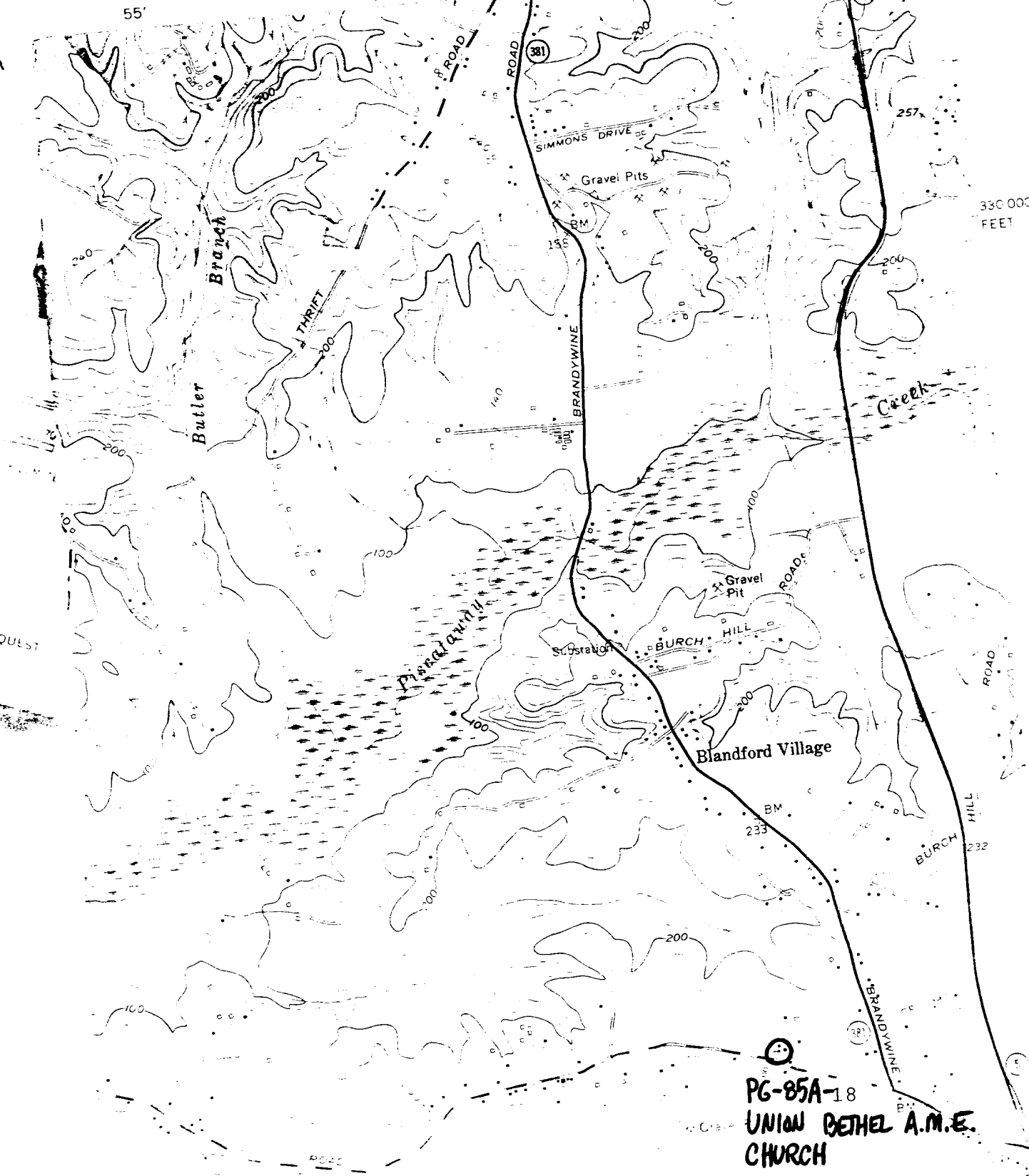

PG-85A-18
UNION BETHEL A.M.E.
CHURCH

BRANDYWINE DIST.

№ 11

Prince George County

Scale, 1/2 Inches to the Mile.



TEE BEE BUSINESS NOTICES.

J. E. Huntt.
Dealer in Dry Goods and Groceries,
Patent Medicines, Boots, Shoes, Paints,
Oils, Glass, Dye Stuffs, and Hardware,
Fancy Goods, Hats, Caps, etc.

William A. Gibbons,
Cabinet Maker and Undertaker

SPRING GROVE

John A. Coe,
Dealer in Dry Good, Groceries and
General Country Produce.

Note: The figures on the Roads shows the distance in Rods
From junction to junction thereof.

Entered according to Act of Congress in the year 1878 by G.M. Hopkins, in the Office of the Librarian of Congress at Washington D.C.

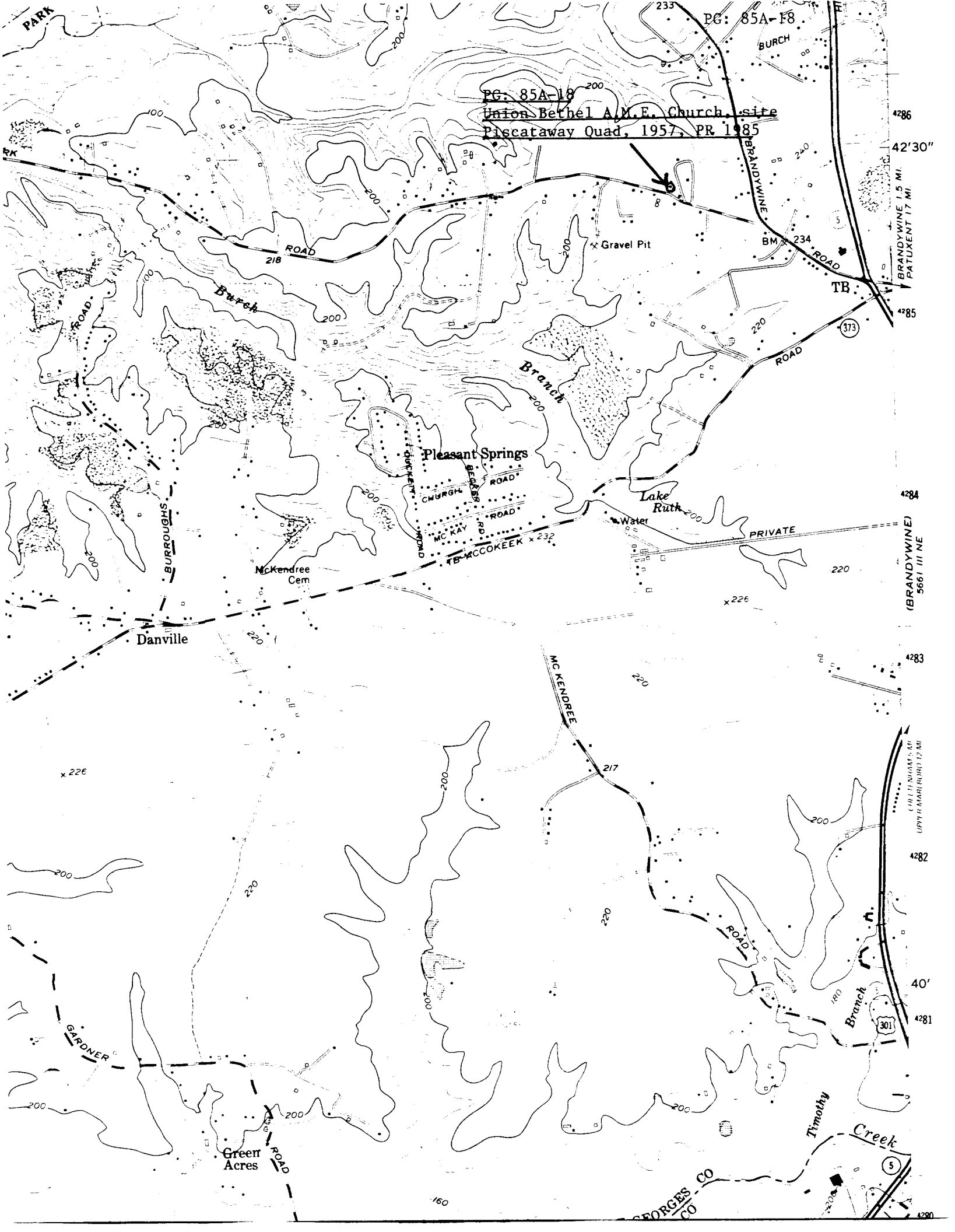

PG: 85A-18
Union Bethel A.M.E. Church site
Piscataway Quad, 1957, PR 1985

PG: 85A-F8

4286
42'30"
BRANDYWINE 1.5 MI.
PATUXENT 1.7 MI.

(BRANDYWINE)
5661 III NE

4284

4283

4282

40'
4281

4280

UPPER MARIANO S. DEP
UPPER MARIANO S. DEP

GEORGES CO

Timothy Creek

301

5

160

Green Acres

ROAD

GARDNER

Danville

McKendree Cem

Pleasant Springs

Water

Lake Ruth

Branch

Burch

ROAD

218

x Gravel Pit

BM 234

TB

373

ROAD

PRIVATE

x 226

217

McKENDREE

BURROUGHS

ROAD

PARK



NAME BETHEL A.M.E. CHURCH - PARSONAGE #85A-18

LOCATION FLORAL PARK Rd NEAR BRANDYWINE Rd

FACADE SW T.B., Md

PHOTO TAKEN 7/31/74 MOWYER